

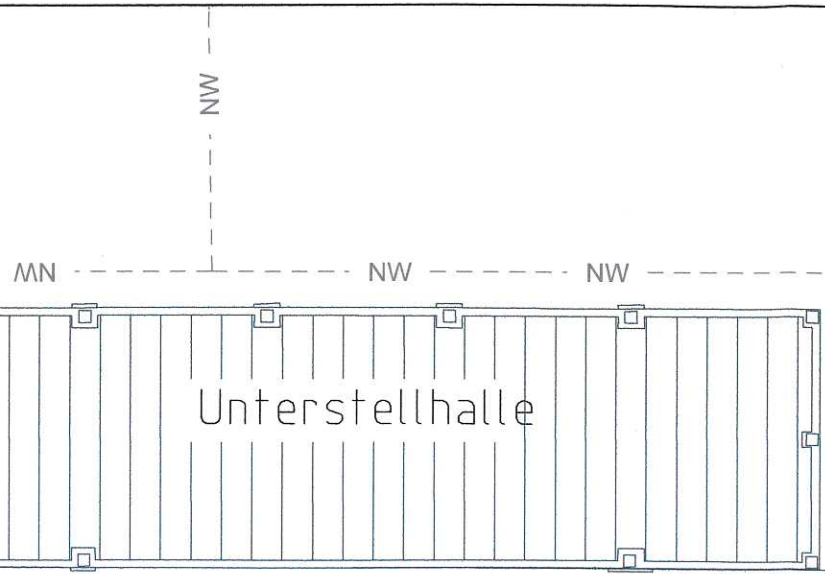

WEV
Maßstab 1 : 2 500
25 0 25 50 75 100 m

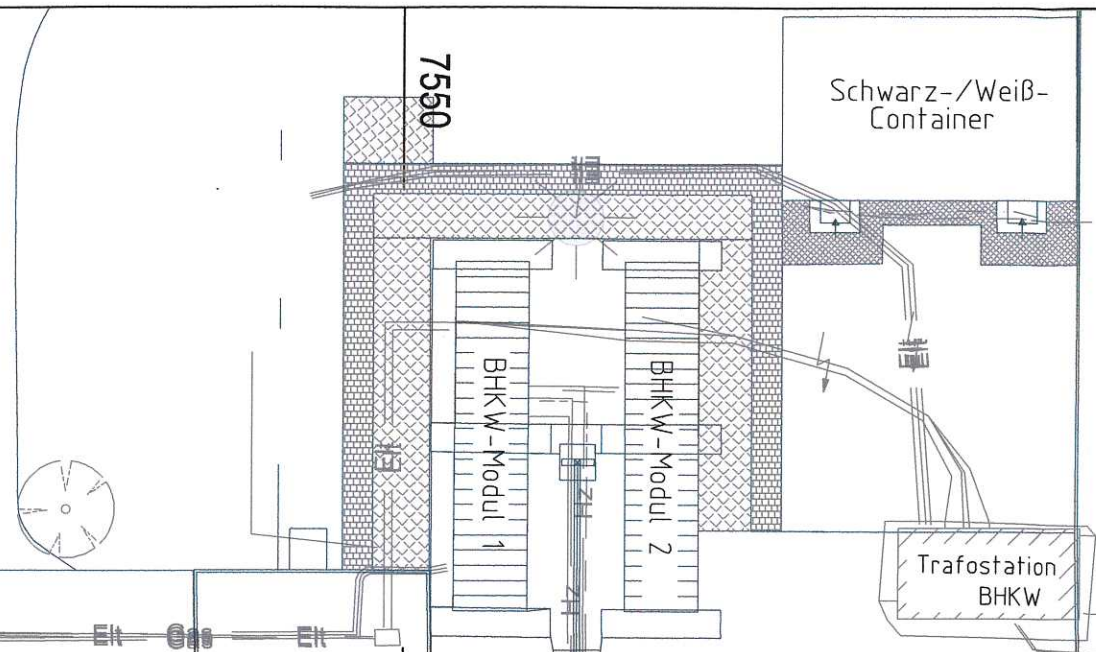

Unterstellhalle



Schwarz-/Weiß-Container

BHKW-Modul 1
BHKW-Modul 2

Trafostation BHKW

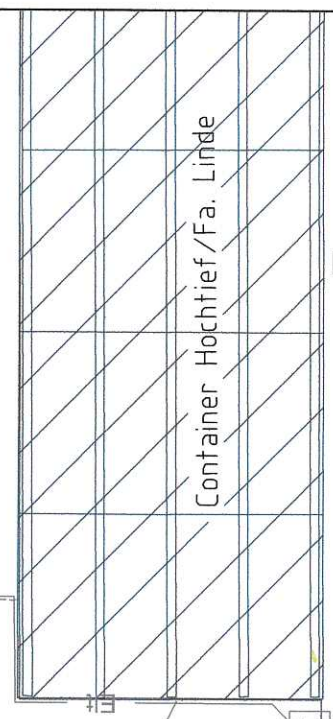

Container Hochtief/Fa. Linde

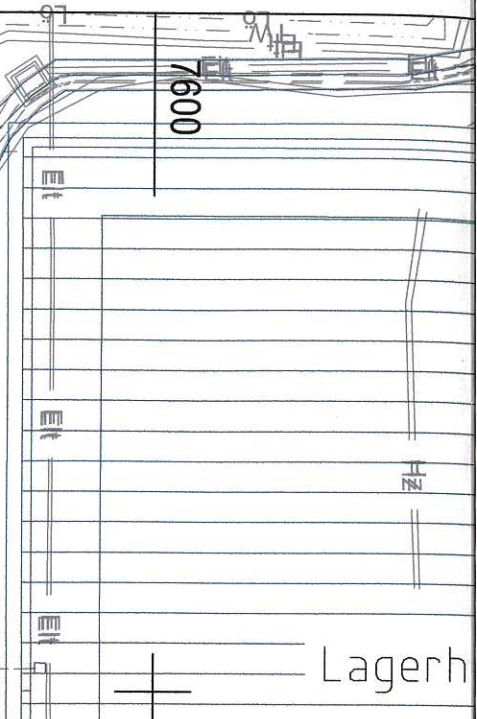

Lagerhalle

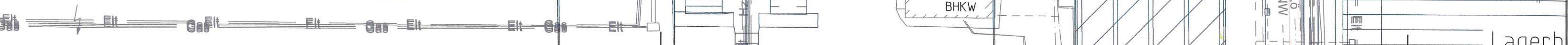

128.47
Betonfläche

Neubau Hochregal

Neubau stehender Heizölbehälter

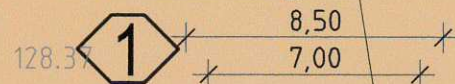

Hochregal

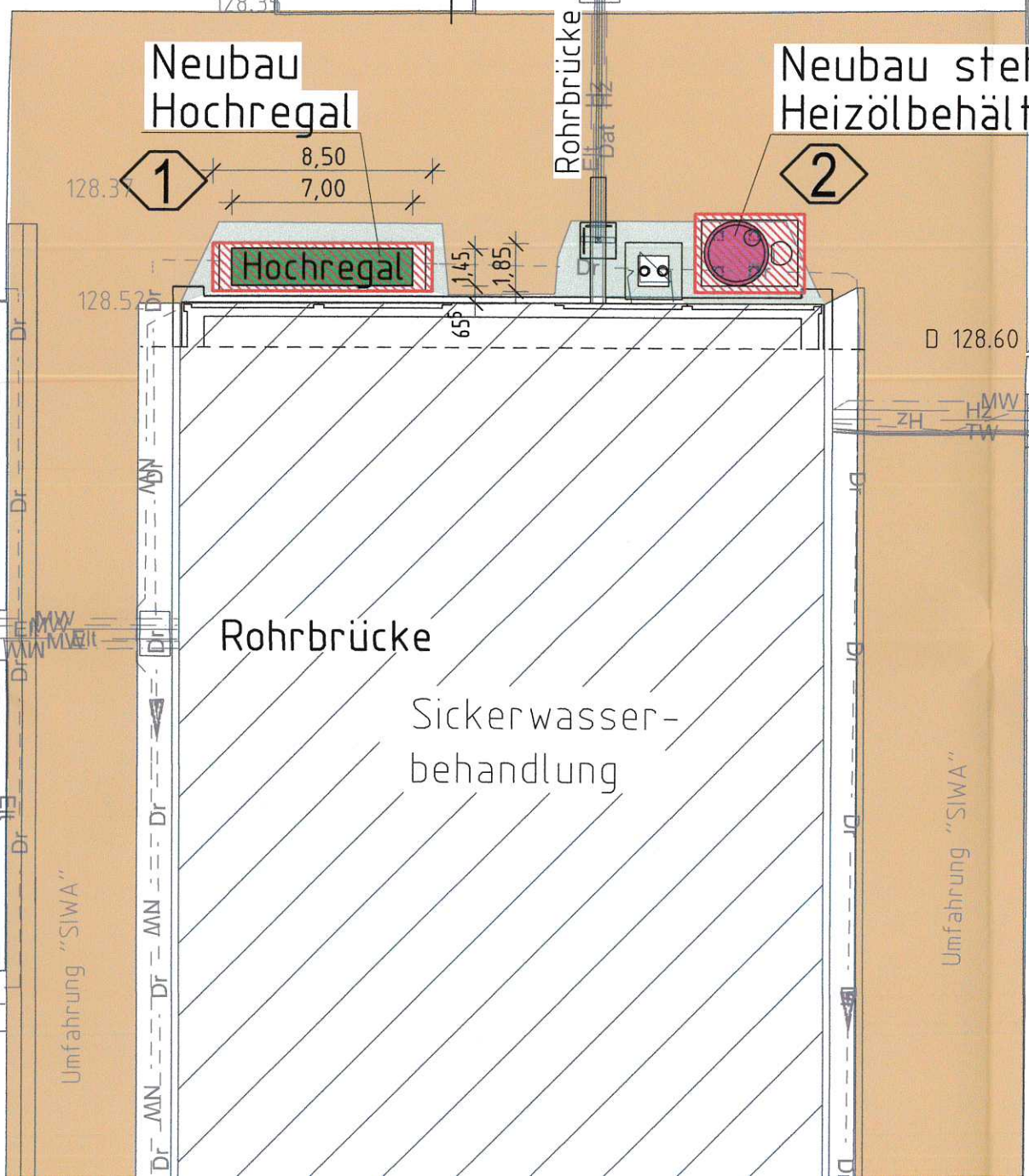

Rohrbrücke

Rohrbrücke

Sickerwasser-
behandlung

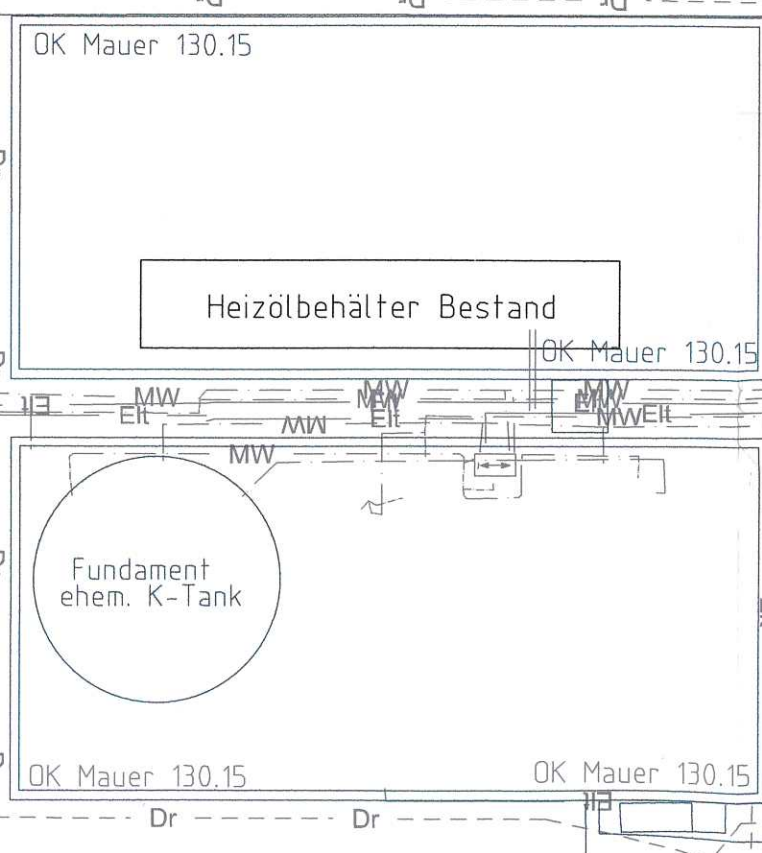
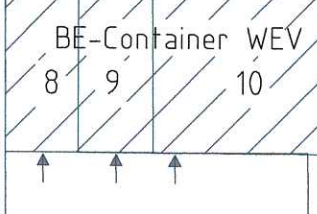
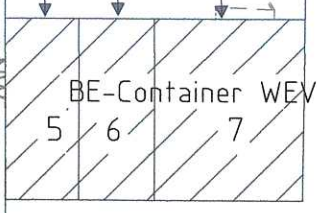
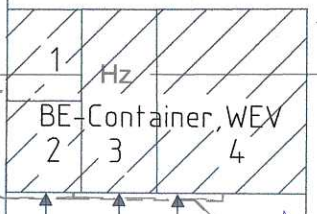
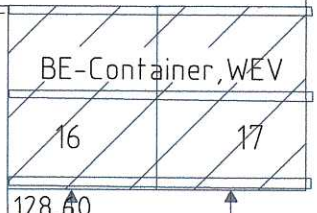

Heizölbehälter Bestand

Fundament
ehem. K-Tank

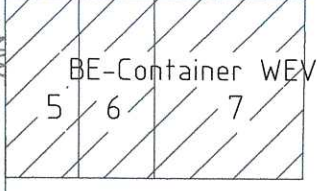

Kleinkläranlage

D:128.60

D:128.70

D:128.66

Umfahrung "SIWA"

Umfahrung "SIWA"

Erdung:
 Die Erdung des Neuen Heizölbehälters
 und des Hochregallagers ist an die
 Bestandserdung Gebäude Sicker-
 wasserbehandlung anzuschließen.

Hochregallager²⁾
 Abmessungen ca.
 7000 x 1450 x 3615 mm

Schnitt x-x; M 1:100

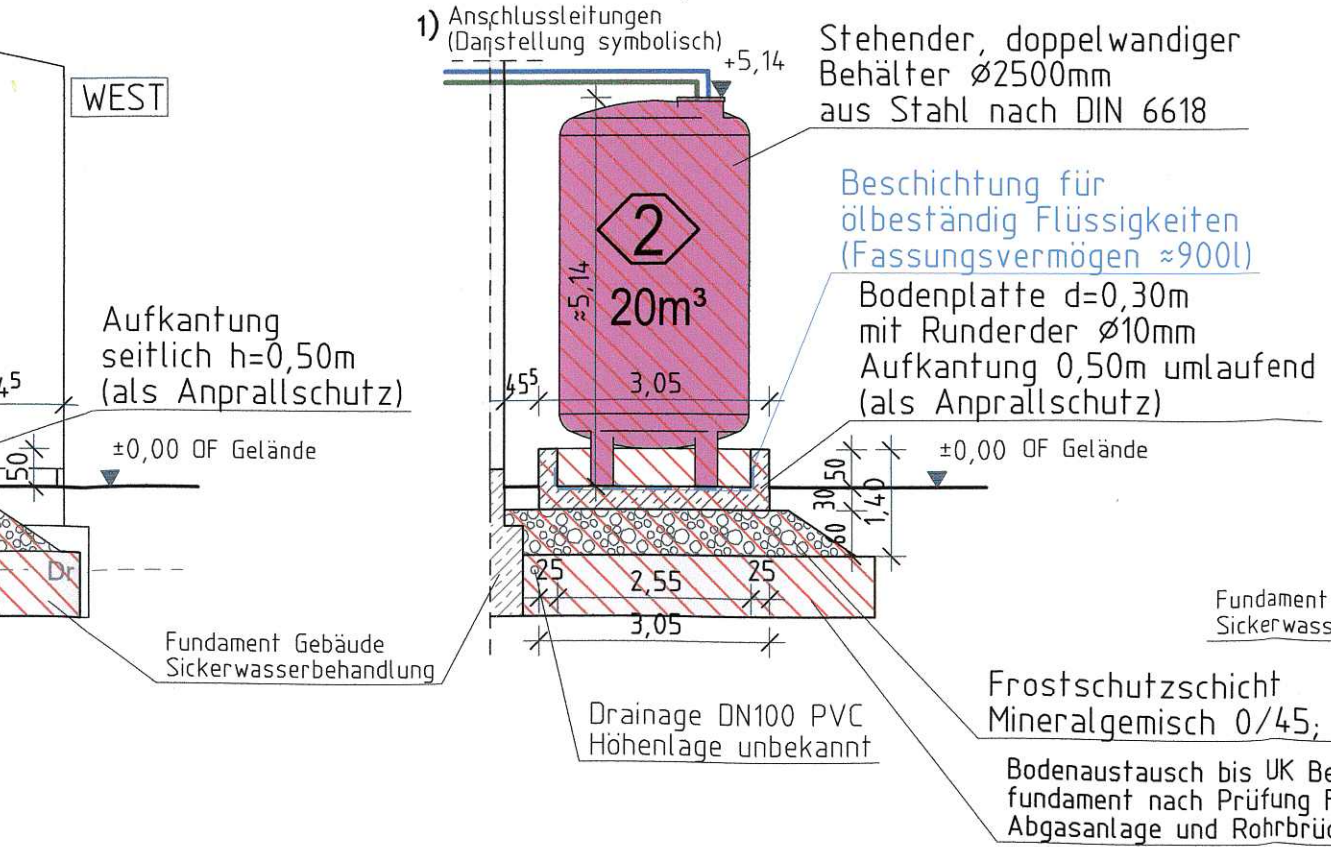

Schnitt z-z; M 1:100

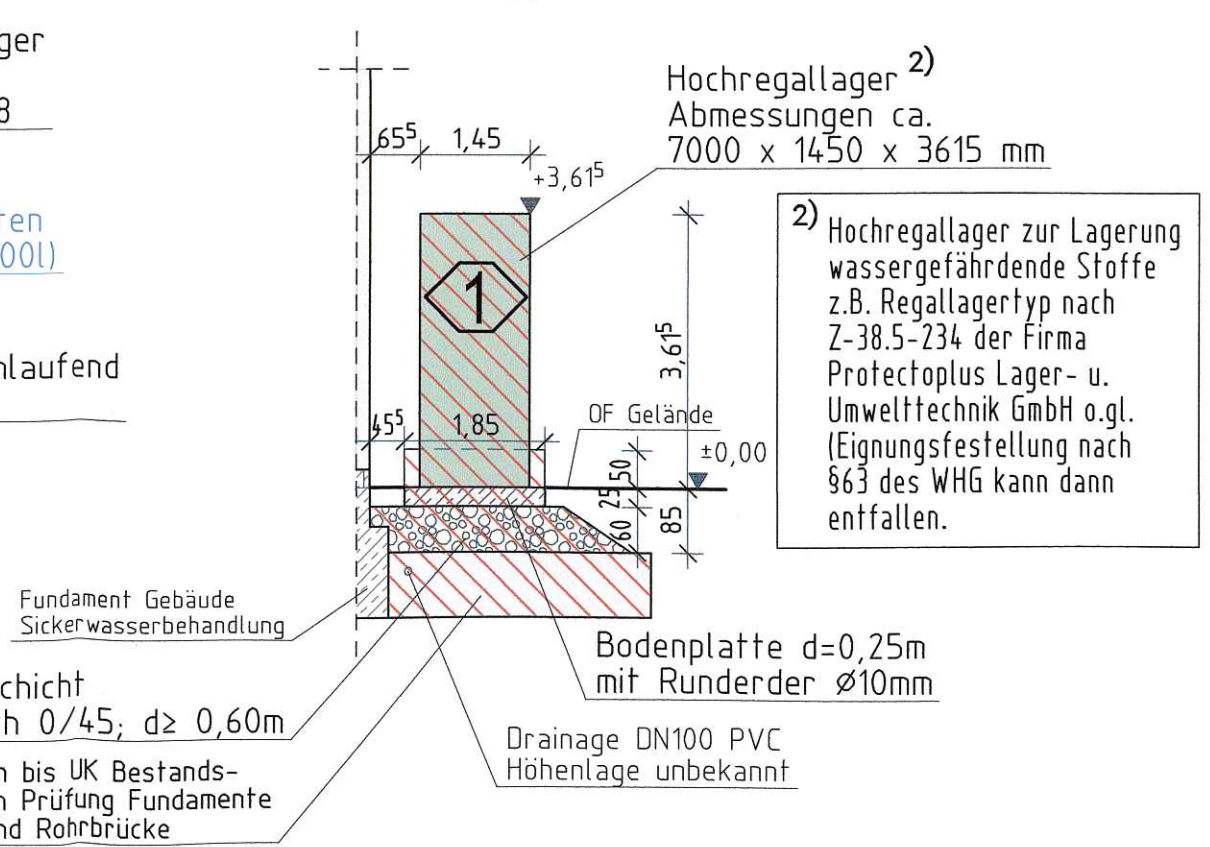

Legende Bestand:

Mischwasser	----	MW	---
Regenwasser	----	NW	---
Drainage	----	Dr	---
Trinkwasser	----	TW	---
Heizleitung	----	Hz	---
Gasleitung	----	Gas	---
Elt.-Kabel	----	Elt	---
Steuerkabel	----	Dat	---
Löschwasser	----	Lö	---
Furstücksgrenze	----		---

Legende Umbau:

Neubau	
Rückbau	
Bodenplatte	
Heizöltank	
Hochregal	
Elt.+ Steuerkabel	
Leitung Heizöl	

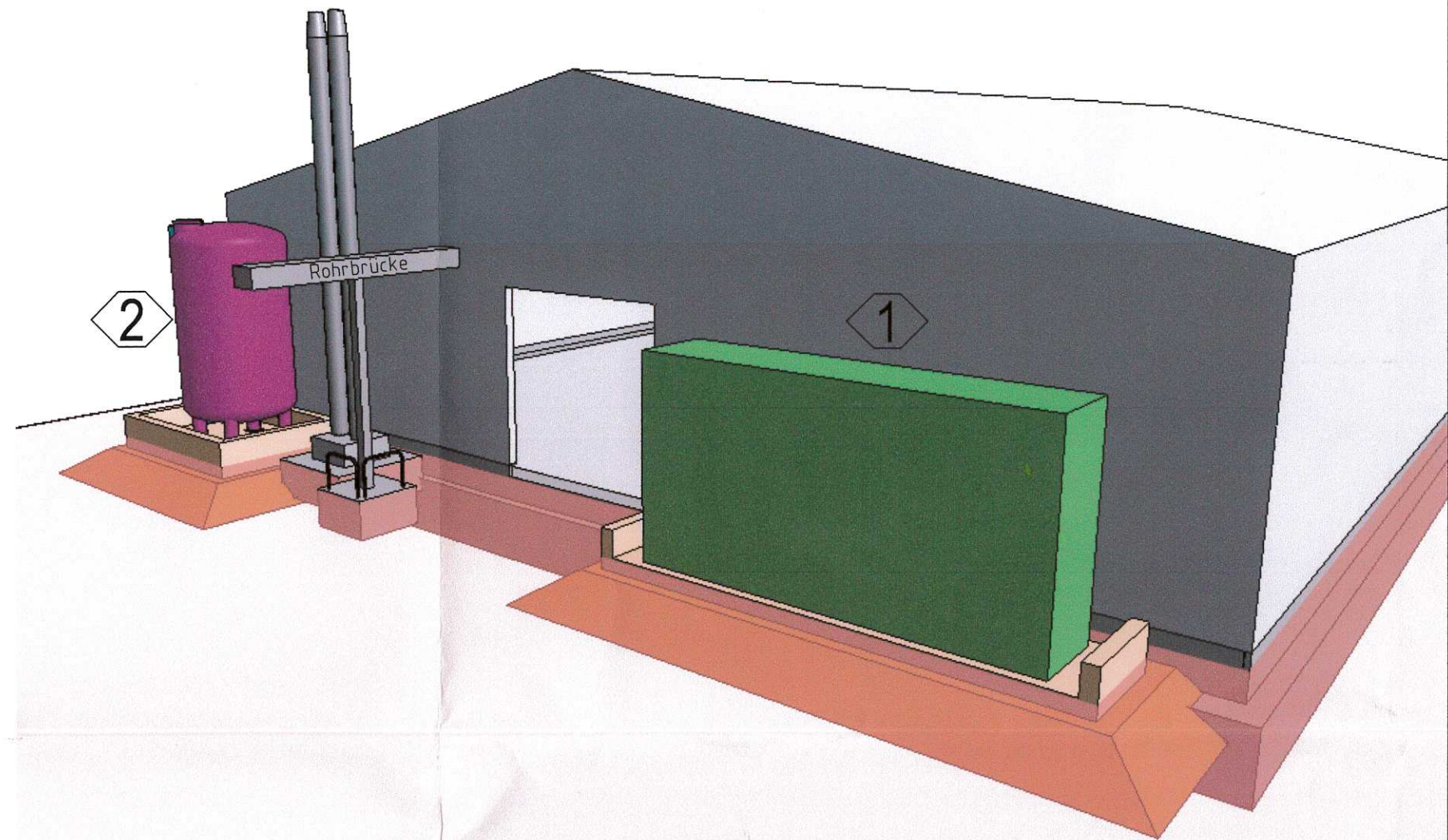

Neubau

1 Hochregallager (genehmigungsfrei gem. § 61 Abs. 1 Nr. 15c SächsBO)

2 Heizölbehälter